

1. Unscrew the handle
2. Pull off the cover
3. Undo crosshead screw and carefully pull microswitch housing#] from shaft.
4. Remove the two screws on the rosette. Remove chrome rosette
5. Remove the three screws from the cartridge holder

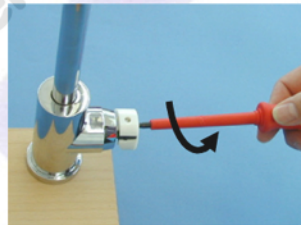

5. Remove the ceramic cartridge noting its position relative to the main body.

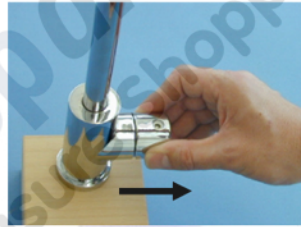

6. First look at the defective microswitch:

- Note the length of the cable protruding to the microswitch
Pull out the cable

- Thread the new microswitch cable through the hole leaving the microswitch cable as noted above

7. Replace the cartridge and parts in reverse order.